

Unfinished storage: 175 sq. ft.  
 Garage: 893 sq. ft.  
 Porches: 459 sq. ft.  
 from outside exterior walls. Second floor two story space counted as half. All calculations are approximate.



First Floor



Second Floor

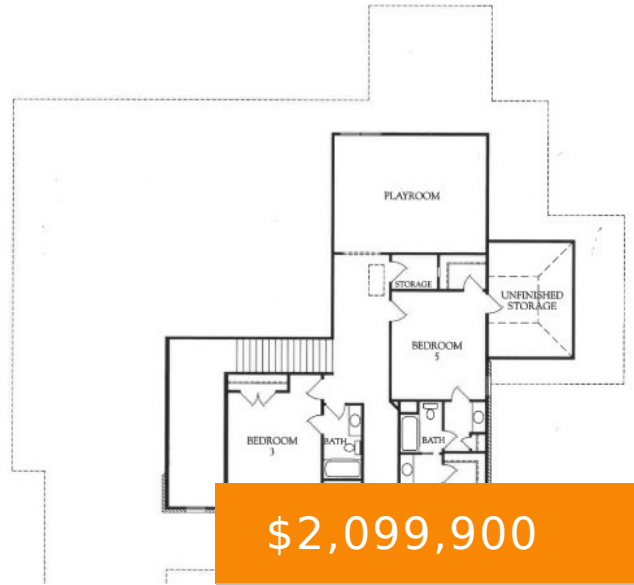

**\$2,099,900**

**1007 LAGUNA DRIVE, FRANKLIN, TN, US,**

<https://therealtoramy.com>

Grand Opening of Award Winning Builder Turnberry Homes  
 Newest Estate Neighborhood - Laguna - Excellent Location and  
 Only 5 Homesites! Award Winning Builder - Turnberry Homes.  
 Popular Nottingham Floor Plan. Vaulted Family Room w/Built-ins,  
 Vaulted Office, Primary and Guest Suites on Main Level,  
 Expanded Laundry Room - Covered Back Porch, Bonus Room,  
 Walk-in Storage, 3-Car [...]

- 5 beds
- 4 baths
- Residential
- Single Family Residence
- Active
- 4763 sq ft

**Rooms**



Room type	Dimensions
Bedroom 1	18x18
Bedroom 2	15x14
Bedroom 3	14x12
Bedroom 4	14x12
Bonus Room	17x13
Dining Room	16x12
Kitchen	15x14
Living Room	19x19

## Building Details

**Cooling features:** Dual, Electric

**ParkingTotal:** 3

**Heating:** Dual, Natural Gas

**Exterior material:** Brick

**Parking:** Attached

**ArchitecturalStyle:** Traditional

**NewConstructionYN:** Yes

**Basement:** Crawl Space

**Roof:** Shingle

## Amenities & Features



**Waterfront available:** No

**AttachedGarageYN:** Yes

**PoolPrivateYN:** No

**ExteriorFeatures:** Garage Door Opener,  
Irrigation System

**Amenities:** Dishwasher, Disposal, Microwave

**GarageYN:** Yes

**FireplaceYN:** Yes

**Security Features:** Smoke Detector(s)

**Utilities:** Electricity Available, Water Available

**Features:** Ceiling Fan(s), Entry Foyer, Extra  
Closets, High Ceilings, Pantry, Primary Bedroom  
Main Floor, Storage, Walk-In Closet(s)

